

Urgent Return receipt Expand Group Restricted Prevent Copy Confidential

寄件者: 熊錦英 >
寄件日期: 2024年10月16日星期三 17:19
收件者: William Shu Tai WONG/PLAND
附件: 20241016_160914.jpg; 20241015_200548.jpg; 20241015_200206.jpg; 20241016_171228.jpg; 20241016_171735.jpg
類別: Internet Email

回復政府意見.

退換反10月15號16號所有文件.

依家經考慮後，會打算提供一輛輕型貨車上落貨位
和一輛私家車位。現提經修改的圖布局圖
能後行車路線分析圖及申請表格退換頁。

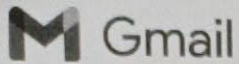

Fwd: D.D. 38 Lot 147 S.A, 175 RP & 176 S.B ss.2



2024年10月16日 下午3:57

----- Forwarded message -----

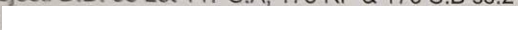
寄件者 : 
Date: 2024年10月15日 週二 17:42
Subject: D.D. 38 Lot 147 S.A, 175 RP & 176 S.B ss.2
To: 

Regarding the parking space, we are making some adjustments. There are currently two parking spaces at the application site, one measures approximately 2.8 meters wide and 6 meters long, primarily used for loading and unloading goods; the other measures about 2.6 meters wide and 5 meters long, mainly designated for visitor use. We only have deliveries two to three times a month, each lasting about 10 to 15 minutes. Customers typically take around 5 minutes for their shopping. We have enough staff to manage the vehicle situation, and we do not have vehicles parked long-term in these spaces. Therefore, we believe that these two parking spaces are sufficient to meet our needs.

從 Outlook 傳送

 D.D. 38 Lot 147 S.A, 175 RP & 176 S.B ss.2-模型.pdf
778K

LAYOUT PLAN

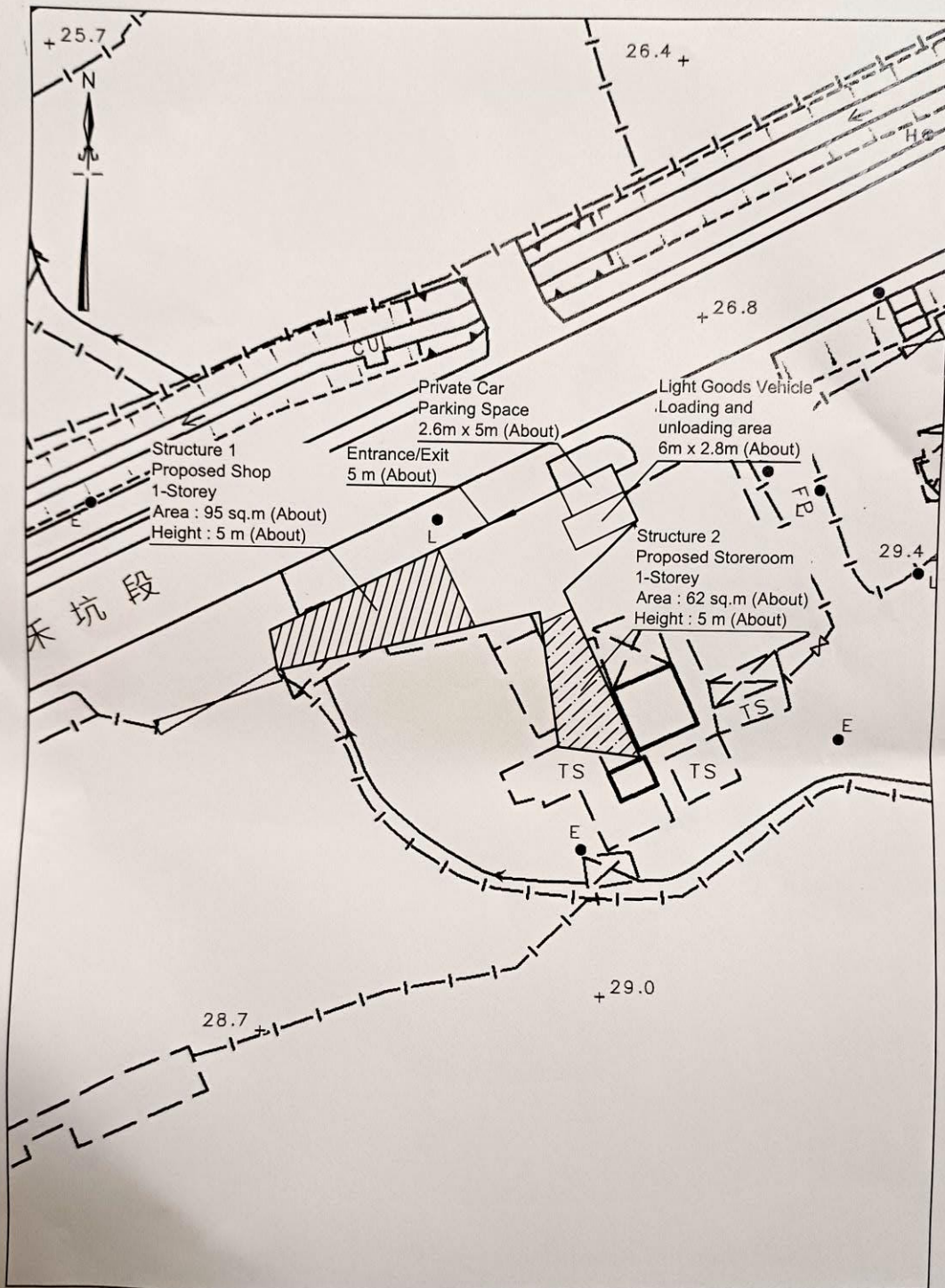

卓 弘 測 量 服 務 公 司
CHUO WANG SURVEY SERVICES COMPANY

Scale : 1 : 500
Survey Sheet No. : 3-NW-25B
Date : October 2024

7. Anticipated Completion Time of the Development Proposal
擬議發展計劃的預計完成時間

Anticipated completion time (in month and year) of the development proposal (by phase (if any)) (e.g. June 2023)
 擬議發展計劃預期完成的年份及月份 (分期 (倘有)) (例: 2023 年 6 月)
 (Separate anticipated completion times (in month and year) should be provided for the proposed public open space and Government, institution or community facilities (if any))
 (申請人須就擬議的公眾休憩用地及政府、機構或社區設施 (倘有) 提供個別擬議完成的年份及月份)

May 2027

8. Vehicular Access Arrangement of the Development Proposal
擬議發展計劃的行车通道安排

<p>Any vehicular access to the site/subject building? 是否有車路通往地盤 / 有關建築物?</p>	<p>Yes 是 No 否</p>	<p><input checked="" type="checkbox"/> There is an existing access. (please indicate the street name, where appropriate) 有一條現有車路。(請註明車路名稱(如適用)) Sha Tau Kok Road - Wo Hang</p> <p><input type="checkbox"/> There is a proposed access. (please illustrate on plan and specify the width) 有一條擬議車路。(請在圖則顯示, 並註明車路的闊度)</p>
<p>Any provision of parking space for the proposed use(s)? 是否有為擬議用途提供停車位?</p>	<p>Yes 是 No 否</p>	<p><input checked="" type="checkbox"/> Please specify type(s) and number(s) and illustrate on plan) 請註明種類及數目並於圖則上顯示)</p> <p>Private Car Parking Spaces 私家車車位 _____</p> <p>Motorcycle Parking Spaces 電單車車位 _____</p> <p>Light Goods Vehicle Parking Spaces 輕型貨車泊車位 _____</p> <p>Medium Goods Vehicle Parking Spaces 中型貨車泊車位 _____</p> <p>Heavy Goods Vehicle Parking Spaces 重型貨車泊車位 _____</p> <p>Others (Please Specify) 其他 (請列明) _____</p>
<p>Any provision of loading/unloading space for the proposed use(s)? 是否有為擬議用途提供上落客貨車位?</p>	<p>Yes 是 No 否</p>	<p><input checked="" type="checkbox"/> Please specify type(s) and number(s) and illustrate on plan) 請註明種類及數目並於圖則上顯示)</p> <p>Taxi Spaces 的士車位 _____</p> <p>Coach Spaces 旅遊巴車位 _____</p> <p>Light Goods Vehicle Spaces 輕型貨車車位 _____</p> <p>Medium Goods Vehicle Spaces 中型貨車車位 _____</p> <p>Heavy Goods Vehicle Spaces 重型貨車車位 _____</p> <p>Others (Please Specify) 其他 (請列明) _____</p>